

KL 8

## STORAGE TANKS - HORIZONTAL Ø1800

type SZN 1800

pressure series PN6, PN10, PN16

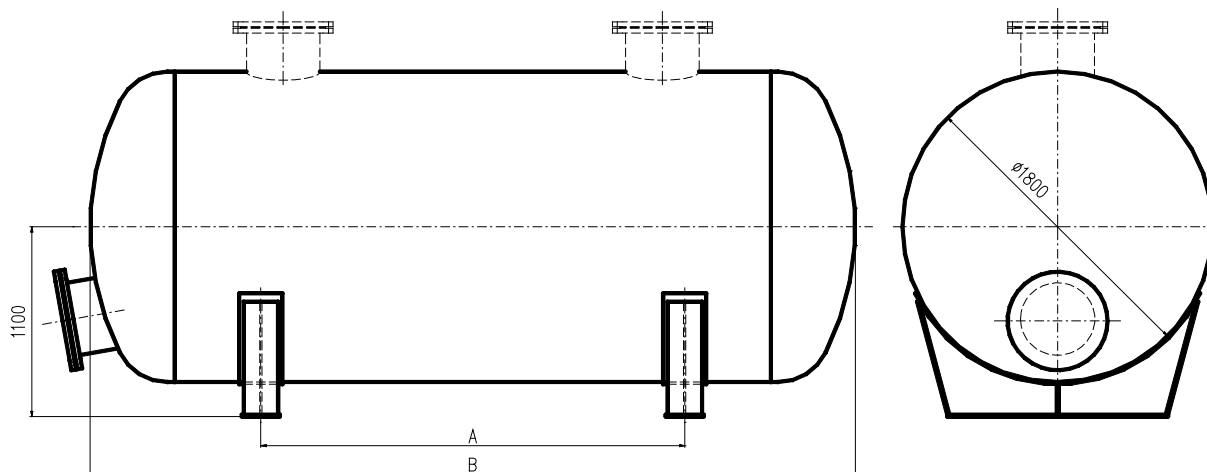

Model range	Tank capacity (m <sup>3</sup> )	A (mm)	B (mm)	Weight (kg)
5	5,47	1200	2480	2500
7	6,71	1800	2980	3000
8	7,95	2200	3480	3500
9	9,19	2900	3980	3800
12	11,67	3900	4980	4500
14	14,14	4900	5980	5200
17	16,62	5900	6980	5800
22	21,57	7900	8980	6000

Material of the tanks: 11375; 11416; 17240; 17248 (another material upon customer's request)

Storage tanks are used for storage of feeding water, additional water and another liquid. According to the utilisation, the tank is equipped with a level gauge, discharge, platform, manometers, thermometers, safety valve etc.

Dimensions, number and location of connections on the tank are decided upon according to specific requirements.

Other dimensions of tanks upon request.

Dimensions listed in the table are informative, weight is specified for PN16.

SEA CZ, a.s. zapsána v OR u Krajského obchodního soudu v Brně, oddíl B, vložka 3214

Výpusta 400, 760 01 Zlín

tel. 577 220 351-4

fax 577 220 357

e-mail: seacz-zl@seacz.cz

KB Zlín, č.ú. 27-1922340217/0100

IČO 25588664

www.seacz.cz

Tyršova 469, 280 00 Kolín 2

tel. 321 729 249

fax 321 722 809

e-mail: seacz-kol@seacz.cz

KB Kolín, č.ú. 27-4397410267/0100

DIČ 303-25588664