

KL 9

PRESSURE VESSELS - VERTICAL type STN

pressure series PN6, PN10, PN16

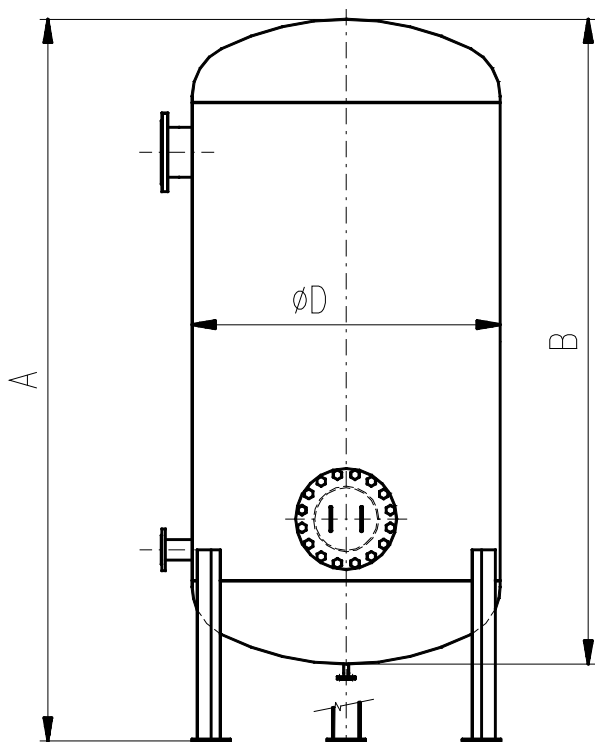

Model range	Tank capacity (m ³)	A (mm)	B (m)	ØD (mm)
80	0,8 – 1,4	B+500	1,6 – 3,3	800
100	1 – 2,6		1,6 – 3,5	1000
120	2 – 4		1,9 – 3,7	1200
140	3,5 – 5		2,4 – 3,8	1400
160	4,5 – 6		2,5 – 3,9	1600
180	6 – 8		2,8 – 4	1800
200	9 – 14		3,2 – 5,6	2000
250	17,5 - 22		3,9 – 4,9	2500

Material of the tanks: 11375; 11416; 17240; 17248 (another material upon customer's request).

Vertical pressure vessels can be used in energy and other operations as storage tanks of pressure air, expansion vessels, expanders and for other similar purposes.

According to the utilisation, the tank is equipped with a level gauge, discharge, platform, manometers, thermometers, safety valve etc.

Dimensions, number and location of connections on the tank are decided upon according to specific requirements.

Other dimensions of vessels upon request.

Dimensions listed in the table are informative and are decided upon according to specific requirements

SEA CZ, a.s. zapsána v OR u Krajského obchodního soudu v Brně, oddíl B, vložka 3214

Výpusta 400, 760 01 Zlín

tel. 577 220 351-4

fax 577 220 357

e-mail: seacz-zl@seacz.cz

KB Zlín, č.ú. 27-1922340217/0100

IČO 25588664

Tyršova 469, 280 00 Kolín 2

tel. 321 729 249

fax 321 722 809

e-mail: seacz-kol@seacz.cz

KB Kolín, č.ú. 27-4397410267/0100

www.seacz.cz

DIČ 303-25588664